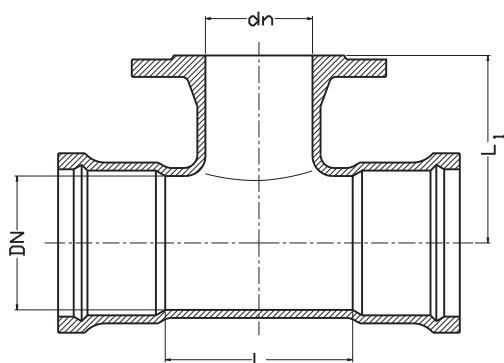

TEU CU FLANSA SI MUFE SOCKET MMA
Flange and Socket Tees MMA

| DN | d _n | L | L ₁ | Masa | DN | d _n | L | L ₁ | Masa |
|-----|----------------|------|----------------|------|-----|----------------|------|----------------|------|
| | | [mm] | | [kg] | | | [mm] | | [kg] |
| 80 | 80 | 170 | 165 | 13 | 300 | 150 | 260 | 310 | 56 |
| 100 | 50 | 155 | 155 | 13 | | 200 | 320 | 320 | 65 |
| | 80 | 175 | 175 | 15 | | 300 | 435 | 340 | 86 |
| 150 | 100 | 190 | 180 | 16 | 400 | 80 | 190 | 355 | 85 |
| | 80 | 180 | 200 | 21 | | 100 | 210 | 360 | 87 |
| | 100 | 200 | 205 | 23 | | 150 | 270 | 370 | 100 |
| 200 | 150 | 260 | 220 | 28 | | 200 | 330 | 380 | 105 |
| | 80 | 180 | 225 | 29 | | 250 | 390 | 390 | 114 |
| | 100 | 200 | 230 | 31 | 300 | 420 | 400 | 117 | |
| | 150 | 260 | 245 | 37 | 400 | 560 | 420 | 158 | |
| 250 | 200 | 320 | 260 | 43 | 500 | 100 | 215 | 420 | 107 |
| | 80 | 185 | 265 | 38 | | 150 | 275 | 430 | 132 |
| | 100 | 205 | 270 | 40 | | 200 | 330 | 440 | 138 |
| | 150 | 260 | 280 | 45 | | 300 | 450 | 460 | 172 |
| 300 | 200 | 315 | 290 | 53 | | 500 | 650 | 500 | 246 |
| | 250 | 380 | 300 | 62 | 600 | 200 | 340 | 500 | 197 |
| | 80 | 185 | 295 | 48 | | 600 | 770 | 580 | 345 |
| | 100 | 205 | 300 | 50 | | | | | |

Date tehnice:

Flanse conform EN 1092-2: 1999
 Presiune de lucru PN10,PN16
 Executie conform EN 545: 2006.

Caracteristici constructive:

Corp-
 Fonta ductila GJS 500-7 EN 1563:2000
 Executie standard:
 vopsea epoxidica RAL5005 250 μm^(*).

Aviz sanitar emis de PZH

Domenii de utilizare:

In instalatii de apa, apa potabila si alte fluide inerte.

Montaj:

Montajul se poate face in orice pozitie.

* - alte executii la cerere

Technical data:

flanges acc. EN 1092-2
 working pressure PN10,PN16
 version acc. EN 545: 2006

Design features:

Body-
 Nodular castiron GGG50 DIN 1693
 Standard execution:
 epoxide paint RAL5005 250 μm^(*).

Hygienic attest by PZH

Application:

In instalations: for water, potable water and other inert fluids

Assembly:

Assembly from horizontal to vertical position.

*- other executions on request