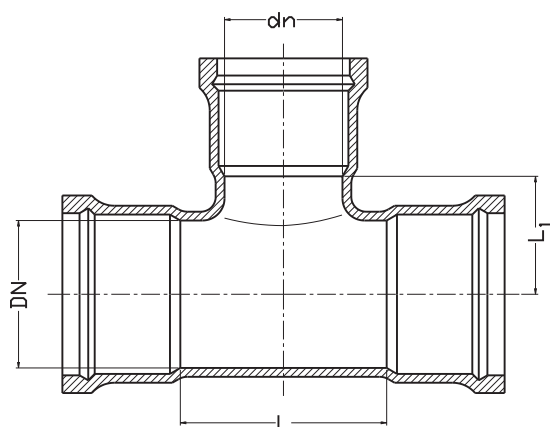

TEU CU MUFE SOCKET MMB
Flange and Socket Tees MMB

DN	d _n	L	L ₁	Masa
	[mm]			[kg]
100	80	170	95	13
	100	190	95	14
150	80	180	120	20
	100	200	125	21
	150	260	130	26
200	80	180	145	26
	100	200	150	29
	150	260	155	34
250	200	320	160	39
	100	200	170	45
	150	260	175	51
	200	320	185	57
300	250	380	190	64
	150	260	205	66
	200	320	205	73
	300	440	220	99

Date tehnice:

Presiune de lucru PN10,PN16
Executie conform EN 545: 2006.

Caracteristici constructive:

Corp-
Fonta ductila GJS 500-7 EN 1563:2000
Executie standard:
vopsea epoxidica RAL5005 250 μm (*).

Aviz sanitar emis de PZH

Domenii de utilizare:

In instalatii de apa, apa potabila si alte fluide inerte.

Montaj:

Montajul se poate face in orice pozitie.

* - alte executii la cerere

Technical data:

working pressure PN10,PN16
version acc. EN 545: 2006

Design features:

Body-
Nodular castiron GGG50 DIN 1693
Standard execution:
epoxide paint RAL5005 250 μm (*).

Hygienic attest by PZH

Application:

In instalations: for water, potable water and other inert fluids

Assembly:

Assembly from horizontal to vertical position.

*- other executions on request